



MOH (Meter-on-House) Process

At Poudre Valley Rural Electric Association, Inc. (PVREA), we are committed to ensuring that your temporary and permanent service installations are completed efficiently. Below is a step-by-step guide to help you through the process.

Temporary Service Installation

**If require Permanent Service Installation, see steps below.*

- 1. Install Temporary Pedestal**

Begin by installing the temporary pedestal at the required location.

- 2. Schedule Inspection**

Contact the appropriate inspection agency to arrange for an inspection of the temporary pedestal installation.

- 3. Inspection Report Submission**

The inspection agency will send the completed report directly to PVREA. Once received, we will review the details and process any necessary deposits.

- 4. Crew Scheduling**

Upon receipt of the inspection report, a crew will be scheduled to connect the temporary pedestal and install the meter. Installation will take place on either **Tuesday or Friday**, depending on when the inspection is received as first come, first serve and depends on emergency/outage service needs.



MOH (Meter-on-House) Process

Permanent Service Installation

**If Temporary Service Installation is not required, see steps 5 through 13 below.*

1. Install Temporary Pedestal

Begin by installing the temporary pedestal at the required location.

2. Schedule Inspection

Contact the appropriate inspection agency to arrange for an inspection of the temporary pedestal installation.

3. Inspection Report Submission

The inspection agency will send the completed report directly to PVREA. Once received, we will review the details and process any necessary deposits.

4. Crew Scheduling

Upon receipt of the inspection report, a crew will be scheduled to connect the temporary pedestal and install the meter. Installation will take place on either **Tuesday or Friday**, depending on when the inspection is received.

5. Purchase Approved Meter Base

Obtain a PVREA-approved meter base from a local electrical supply store. The meter base must be installed on the side of the house in the approved location, as per the specifications provided.

6. Install Meter Base

Once purchased, install the meter base in the approved location.

7. Pay MOH Fee

The MOH fee must be paid before permanent service installation can proceed. Payments can be made by:

- **In-person** at our office
- **Mailing** the payment to our office address

Ensure the address for which you are paying is listed on the payment.

8. Clear Dig Area and ensure trench line is to final grade

Ensure the designated trenching area is clear for installation.

MOH (Meter-on-House) Process

9. Request Trench Installation

Contact **PVREA** or **Get Connected** to request the trench once the meter base is installed and the MOH fee is paid.

10. Notification of Trench Completion

Get Connected will notify PVREA when the trenching is complete.

11. Schedule Permanent Inspection

Contact the inspection agency to request permanent service inspection. This can be done separately from the trenching request.

12. Receive Inspection Release

Once the inspection agency has completed the inspection and released the report, PVREA will review it.

13. Schedule Permanent Installation

Following the inspection release and trench completion, a crew will be scheduled to complete the permanent service installation on either a **Tuesday or Friday**, depending on when the inspection is received as first come, first serve and depends on emergency/outage service needs.

Contact Us

If you have any questions, concerns, or would like to request trench installation, please don't hesitate to reach out to our Engineering Department.

- **PVREA Engineering Phone Number:** (970) 377-6650
 - **Email:** fieldengprojects@pvrea.coop
- **Company Office Hours:** Monday to Friday, 7:30 AM – 4:30 PM (Mountain Time)

-
- **Get Connected**
 - Phone: (970) 218-2711
 - Email: boznaros@hotmail.com

U4801-XL-5T9



Catalog Number	U4801-XL-5T9
Marketing Product Description	5 Terminal Ringless Small Closing Plate Lever Bypass 5th Terminal 9 O'clock Position
UPC	784572288218
Length (IN)	4.844
Width (IN)	13
Height (IN)	19
Brand Name	Milbank
Type	Ringless Meter Socket
Application	Meter Socket
Standard	UL Listed; Type 3R
Voltage Rating	600 Volts Alternating Current
Amperage Rating	200 Continuous Ampere
Phase	1 Phase
Frequency Rating	60 Hertz
Size	4.844L x 13W x 19H
Number Of Cutouts	0
Cutout Size	No Main Breaker
Cable Entry	Overhead or Underground
Terminal	Lay in
Insulation	Glass Polyester
Mounting	Surface Mount

Enclosure G90 Galvanized Steel with Powder Coat Finish

Jaw Quantity	5 Terminal
Bypass Type	Lever Bypass
Number of Meter Positions	1 Position
Equipment Ground	Bonded Ground Strap
Hub Opening	Small Closing Plate
Line Side Wire Range	6 AWG - 350 kcmil
Load Side Wire Range	6 AWG - 350 kcmil
Number Of Receptacles	0

Please consult serving utility for their requirements prior to ordering or installing, as specifications and approvals vary by utility and may require local electrical inspector approval. All installations must be installed by a licensed electrician and must comply with all national and local codes, laws and regulations. Milbank reserves the right to make changes in specifications and features shown without notice or obligation.

FEATURE TABLE		
ITEM	QTY	DESCRIPTION
A	5	U/L MNTG.EMBOSS
B	1	¼ SOLID K.O.
C	1	¼, ½ CONC. K.O.
D	2	1, 1¼, 1½, 2, 2½ CONC. K.O.
E	4	1¼, 1½, 2, 2½, 3 CONC. K.O.

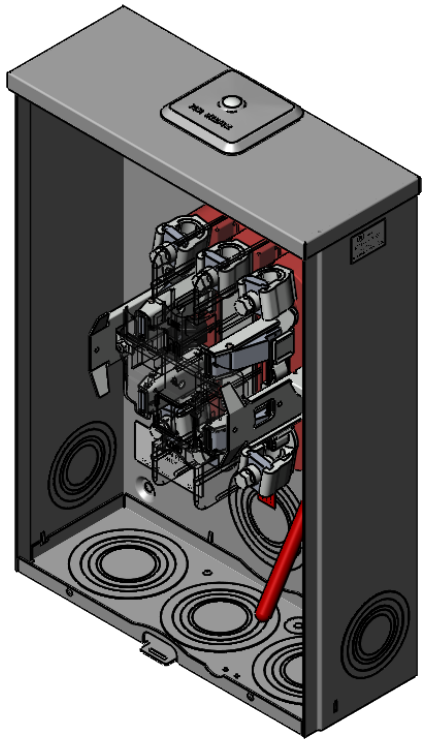
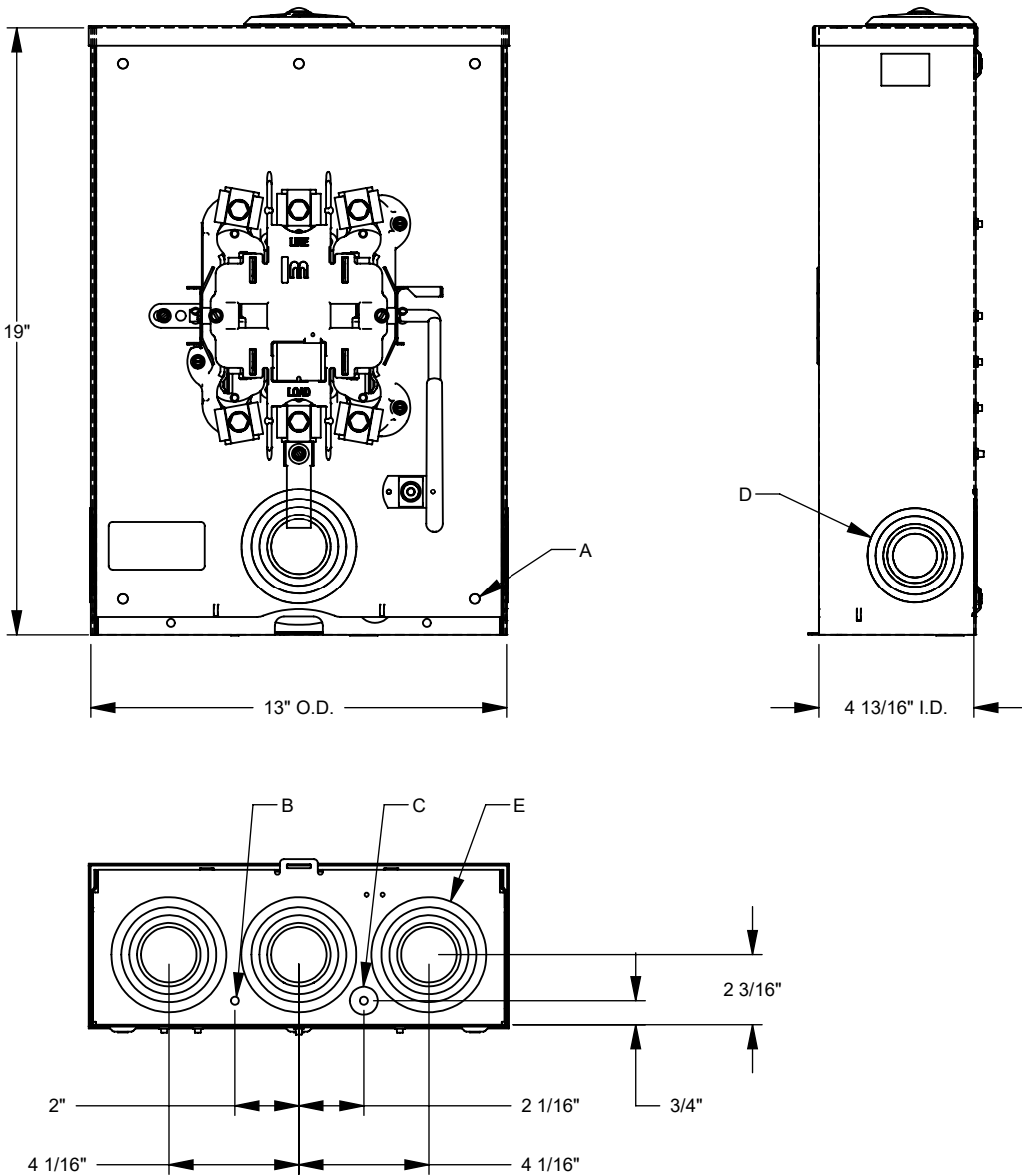

Version:

1

All dimensions are +/- 1/16".
Drawing views are not to scale.

Please consult serving utility for their requirements prior to ordering or installing, as specifications and approvals vary by utility, and may require local electrical inspector approval. All installations must be installed by a licensed electrician and must comply with all national and local codes, laws and regulations. Milbank reserves the right to make changes in specifications and features shown without notice or obligation.

TRENCH SPECIFICATION - SECONDARY ONLY
UR2A-2

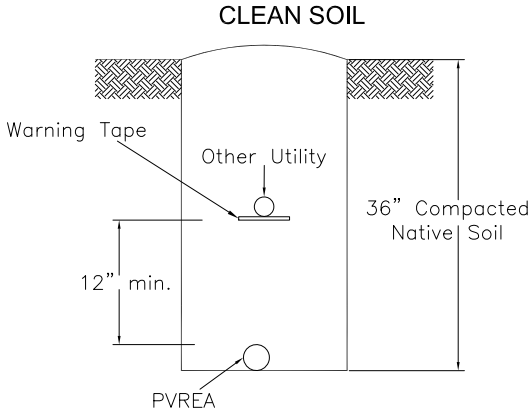

- TRENCHING SPECIFICATION NOTES:
1. DEPTHS SPECIFIED ARE TO FINISHED GRADE.
 2. BACKFILL MUST BE FREE OF ROCKS AND DEBRIS.
 3. SAND BEDDING MAY BE REQUIRED AND WILL BE SPECIFIED BY ENGINEERING DEPARTMENT.
 4. BACKFILLING IS A PART OF ALL TRENCHING UNITS INCLUDING JOINT-USE TRENCHES.
 5. WARNING TAPE IS A PART OF ALL TRENCHING UNITS INCLUDING JOINT-USE TRENCHES.
 6. COMPACTION 80%

TRENCH ROUTE OPTIONS & INSTALLATION NOTES

*Not all possible configurations shown. Call PVREA with questions.

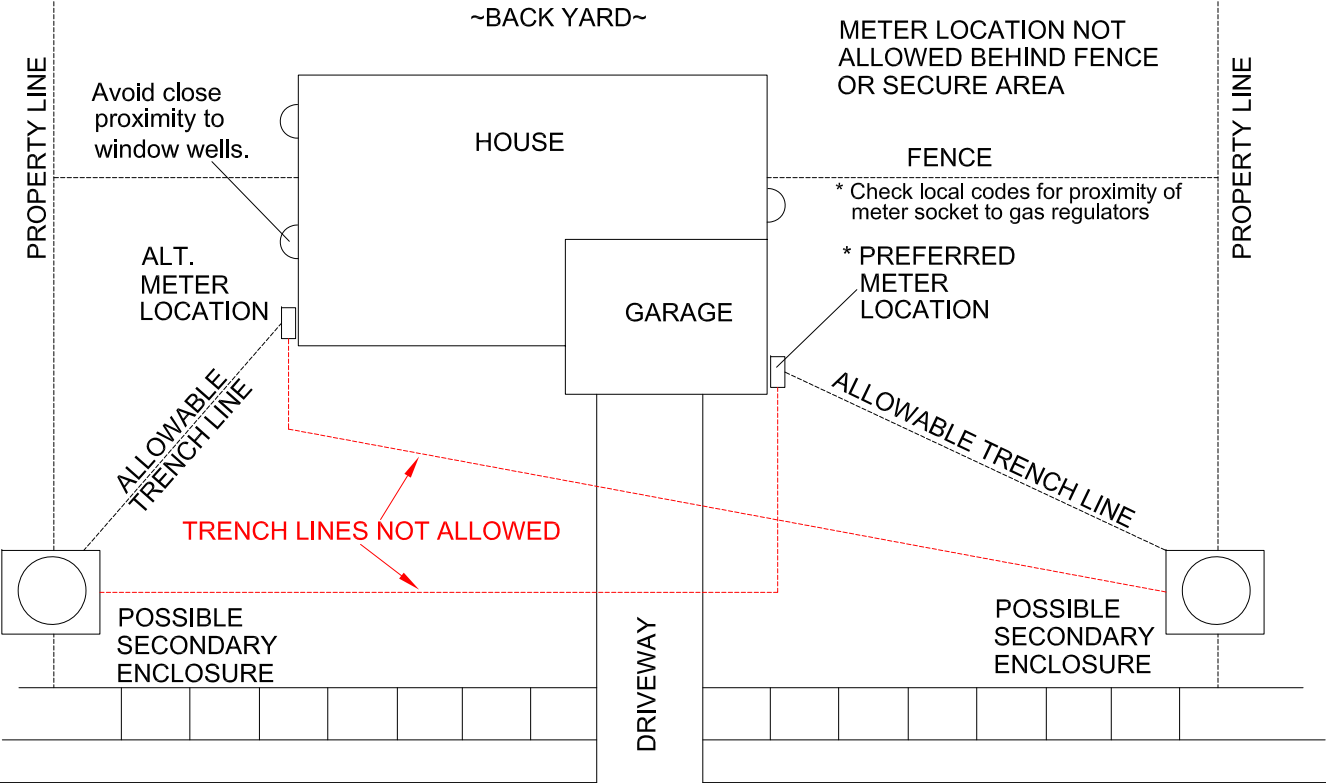

- NOTES:
- 1) IF GRADE CHANGES OCCUR AFTER INSTALLATION OF PVREA FACILITIES, THE BUILDER OR OWNER WILL BE RESPONSIBLE FOR INSURING THAT THE FACILITIES ARE RETURNED TO PROPER DEPTH SPECIFICATIONS.

2) METER SOCKETS SHALL BE READILY ACCESSIBLE
METER SOCKETS SHALL NOT BE INSTALLED BEHIND FENCES OR ON THE BACK OF THE HOUSE OR IN SECURED AREAS. METER SOCKETS MAY BE INSTALLED ON THE SIDE WALLS OF HOUSE OR GARAGE, BUT NOT BEYOND FENCES OR OTHER SECURED AREAS.

3) PVREA WILL SET A METER AFTER THE STATE INSPECTOR HAS APPROVED INSTALLATION.
- 4) NO TRENCH SHALL CROSS THE LOCATION OF A PROPOSED DRIVEWAY OR SIMILAR AREAS WHERE TRENCH SETTLEMENT MAY HAVE AN ADVERSE EFFECT OR CAUSE SIGNIFICANT DAMAGE OR FAILURE TO THE CONSUMER'S PROPERTY.

5) FOR ANSWERS TO ADDITIONAL QUESTIONS CALL PVREA AT (970) 226-1234 OR (800) 432-1012.

6) IF MINIMUM DEPTH AND SEPARATION AT GAS CROSSING IS NOT POSSIBLE, CONDUIT SHALL BE INSTALLED UNDER THE GAS LINE WITH A MINIMUM OF 12" SEPARATION.

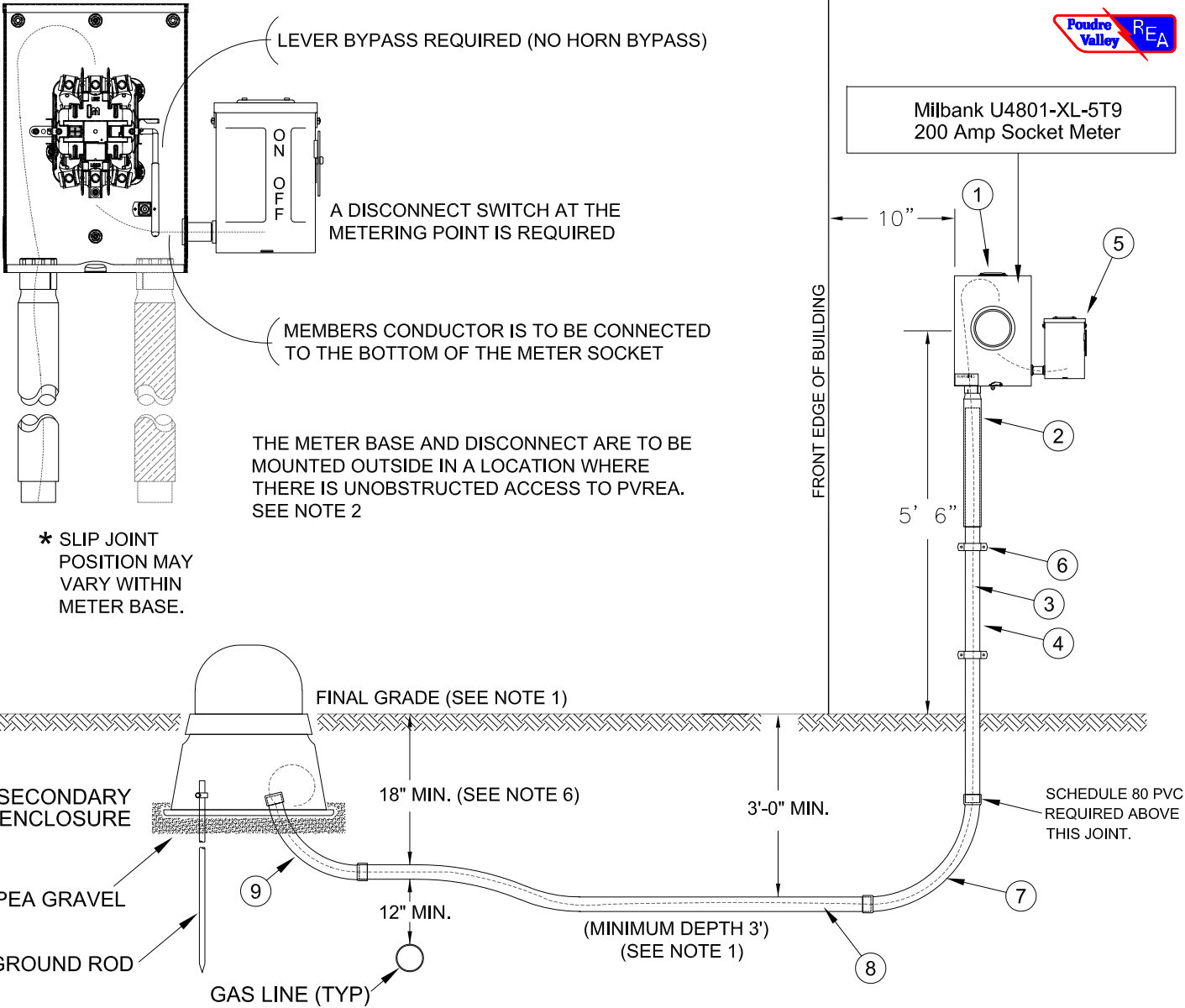

FURNISHED & INSTALLED MATERIALS

BUILDER FURNISHED AND INSTALLED EQUIPMENT	
1. 200A METER BASE - Milbank U4801-XL-5T9	
5. DISCONNECT SWITCH	
PVREA INSTALLED EQUIPMENT (VIA CONTRACTOR)	
2. SLIP JOINT WITH BUSHING LOCKNUTS	
3. SERVICE CONDUCTOR 4/0 TPX	
4. 2" CONDUIT-PVC-SCHEDULE 80	
6. STRAPS AND SCREWS AS REQUIRED	
7. 36" LONG, 18" RADIUS PVC SWEEP AS REQUIRED	
8. 2" CONDUIT-PVC-SCHEDULE 40 OR SCHEDULE 80	
9. SWEEP INTO ENCLOSURE AS REQ'D.	
10. EACH END OF WIRE MARKED FOR IDENTIFICATION	

* PRINT THIS DOCUMENT ON 11X17 PAPER

200 AMP METER SERVICE
SPECIFICATION SHEET
HOUSE MOUNT TYPE

NOTES:

1. All temp services must meet National Electric Code.
2. All temp services must be inspected and approved by the proper governing authority.
3. A PVREA account must be set up and active prior to the temp service being energized.
4. The temp service must be in good working order including the installation of all breakers and GFCI protected outlets.
5. All conductors (line and load), including the ground wire, must be installed.
6. The temp meter socket must have a lever bypass (no horn bypass).
7. The flex conduit must be 2" diameter or less and must be long enough to reach the nearest PVREA enclosure.
8. The flex conduit must reach the PVREA enclosure without creating any tripping hazards.
9. The temp service must be located on the subject property address side of the PVREA enclosure.
10. The line side triplex conductor and #4 CU solid ground wire must be a minimum length of 3' longer than the flex conduit.
11. The property address number must be legible, weatherproof, and securely affixed to the temp service.
12. The temp service must be screwed securely to the post with a minimum of two screws.
13. The post must be a minimum size of 4" x 4" and must be buried to a minimum depth of 2'-6" or be mounted on a self supporting base.
14. 811 Locates are required for the post installation.

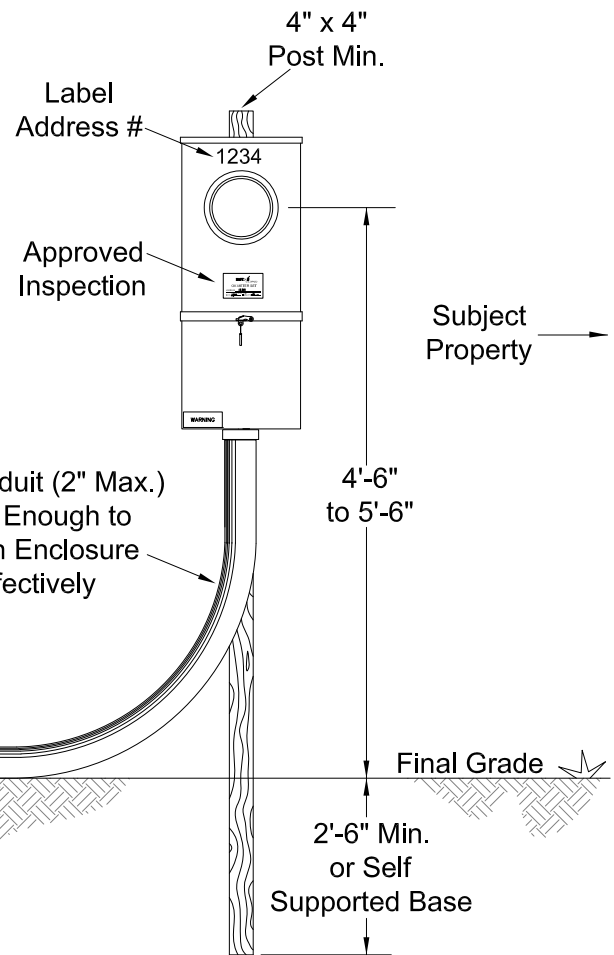
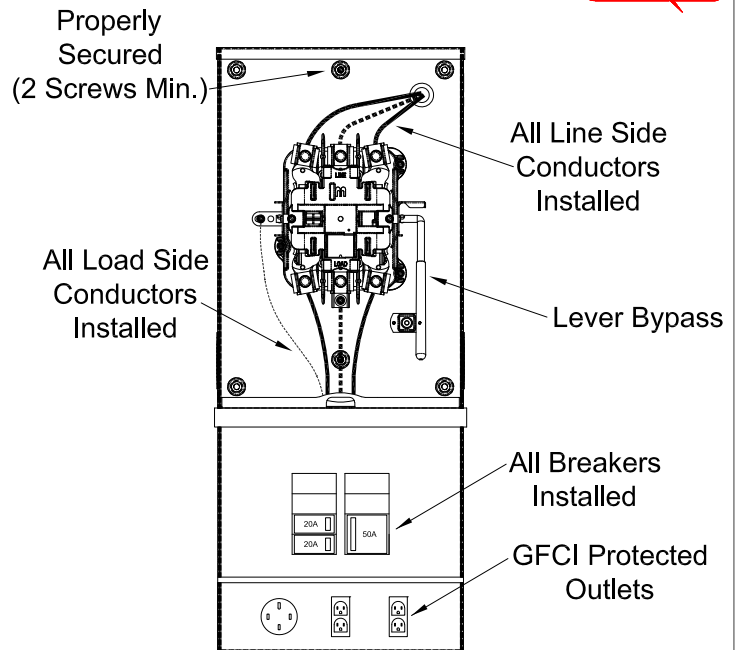

PVREA Enclosure
For Reference Only
DO NOT ENTER

Triples Line Side
Conductor & #4 CU
Solid Ground Wire
(3' Min. Longer than
the Flex Conduit)

Flex Conduit (2" Max.)
Long Enough to
Reach Enclosure
Effectively

Flex Conduit
Must Not Create
Any Tripping
Hazards

Final Grade



DESIGN LIMITS:

TEMPORARY CONSTRUCTION SERVICE
INSTALLATION GUIDE

DATE: 3/28/2022

CHKD: RBP

APPVD: MO

POUDRE VALLEY
RURAL ELECTRIC ASSOCIATION

Temp
Service