



## Overview of the MOH process.

If a temporary service is needed, you will install the temporary pedestal and call the appropriate inspection agency for your inspection. The inspecting agency will send the report directly to PVREA. When this report is received from the inspecting agency, PVREA will set up the account and process deposits if necessary. A crew will be scheduled to connect the temporary pedestal and set a meter on Tuesday or Friday, depending on when the inspection is received.

When you are ready for permanent service, you will need to purchase the PVREA approved meter base from a local electrical supply store and install it on the side of the house in the PVREA approved location. A specification has been attached for reference. The MOH fee will need to be paid by bringing the payment into our office or mailing the payment. Make sure the address you are paying for is listed on the payment. Once the meter base is installed, the fee paid, and the dig area is clear, contact PVREA or Get Connected to request the trench. Get Connected will notify PVREA when the trench is complete. You will also need to call the inspecting agency for your permanent inspection. This can be done independent of the trench request. Once the inspection release is received from the inspecting agency and the trench is complete, a crew will be scheduled to complete the permanent installation on Tuesday or Friday depending on when the inspection is received. All meter installations will be done on Tuesdays and Fridays.

Please contact us with any questions, concerns or trench requests. Our engineering department can be reached at (970) 377-6650 anytime between 7:30 am and 4:30 pm Monday through Friday or by email at [fieldengprojects@pvrea.coop](mailto:fieldengprojects@pvrea.coop). Get Connected can be reached at (970) 218-2711 or [boznaros@hotmail.com](mailto:boznaros@hotmail.com).



**MILBANK**  
ENERGY AT WORK

## U4801-XL-5T9



Catalog Number	U4801-XL-5T9
Marketing Product Description	5 Terminal Ringless Small Closing Plate Lever Bypass 5th Terminal 9 O'clock Position
UPC	784572288218
Length (IN)	4.844
Width (IN)	13
Height (IN)	19
Brand Name	Milbank
Type	Ringless Meter Socket
Application	Meter Socket
Standard	UL Listed; Type 3R
Voltage Rating	600 Volts Alternating Current
Amperage Rating	200 Continuous Ampere
Phase	1 Phase
Frequency Rating	60 Hertz
Size	4.844L x 13W x 19H
Number Of Cutouts	0
Cutout Size	No Main Breaker
Cable Entry	Overhead or Underground
Terminal	Lay in
Insulation	Glass Polyester
Mounting	Surface Mount

Enclosure	G90 Galvanized Steel with Powder Coat Finish
-----------	--

Jaw Quantity	5 Terminal
--------------	------------

Bypass Type	Lever Bypass
-------------	--------------

Number of Meter Positions	1 Position
---------------------------	------------

Equipment Ground	Bonded Ground Strap
------------------	---------------------

Hub Opening	Small Closing Plate
-------------	---------------------

Line Side Wire Range	6 AWG - 350 kcmil
----------------------	-------------------

Load Side Wire Range	6 AWG - 350 kcmil
----------------------	-------------------

Number Of Receptacles	0
-----------------------	---

Please consult serving utility for their requirements prior to ordering or installing, as specifications and approvals vary by utility and may require local electrical inspector approval. All installations must be installed by a licensed electrician and must comply with all national and local codes, laws and regulations. Milbank reserves the right to make changes in specifications and features shown without notice or obligation.

FEATURE TABLE		
ITEM	QTY	DESCRIPTION
A	5	U/L MNTG.EMBOSS
B	1	¼ SOLID K.O.
C	1	¼, ½ CONC. K.O.
D	2	1, 1¼, 1½, 2, 2½ CONC. K.O.
E	4	1¼, 1½, 2, 2½, 3 CONC. K.O.

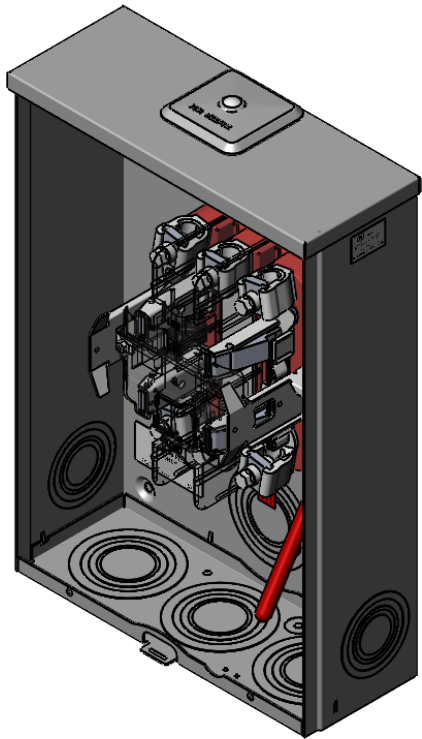
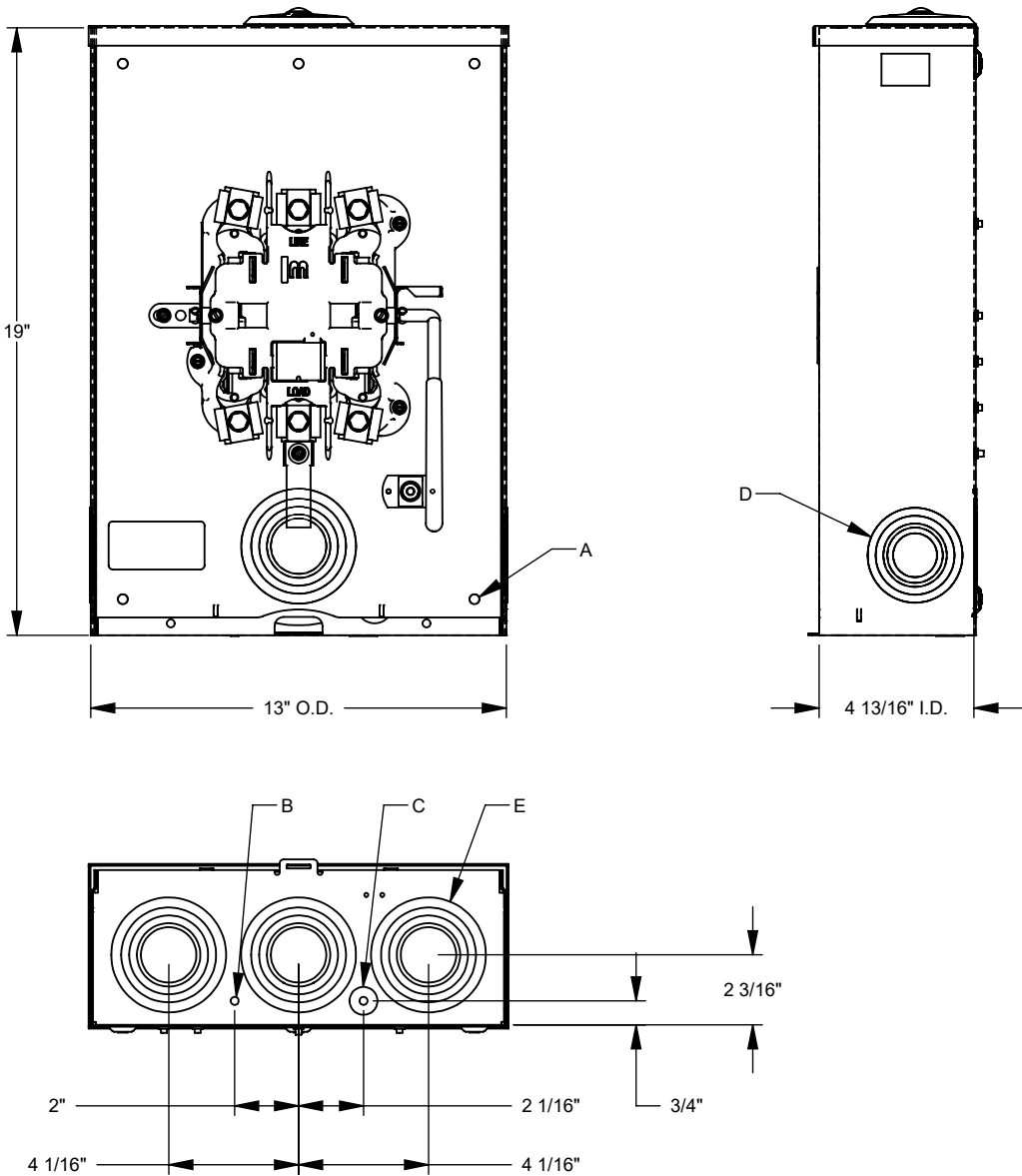

Version:

1

**All dimensions are +/- 1/16".  
Drawing views are not to scale.**

Please consult serving utility for their requirements prior to ordering or installing, as specifications and approvals vary by utility, and may require local electrical inspector approval. All installations must be installed by a licensed electrician and must comply with all national and local codes, laws and regulations. Milbank reserves the right to make changes in specifications and features shown without notice or obligation.

TRENCH SPECIFICATION - SECONDARY ONLY  
UR2A-2

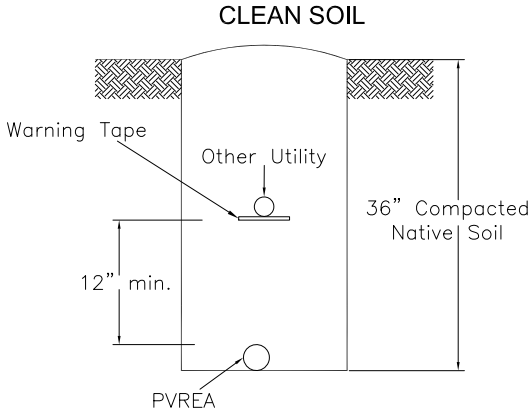

- TRENCHING SPECIFICATION NOTES:
1. DEPTHS SPECIFIED ARE TO FINISHED GRADE.
  2. BACKFILL MUST BE FREE OF ROCKS AND DEBRIS.
  3. SAND BEDDING MAY BE REQUIRED AND WILL BE SPECIFIED BY ENGINEERING DEPARTMENT.
  4. BACKFILLING IS A PART OF ALL TRENCHING UNITS INCLUDING JOINT-USE TRENCHES.
  5. WARNING TAPE IS A PART OF ALL TRENCHING UNITS INCLUDING JOINT-USE TRENCHES.
  6. COMPACTION 80%

TRENCH ROUTE OPTIONS & INSTALLATION NOTES

\*Not all possible configurations shown. Call PVREA with questions.

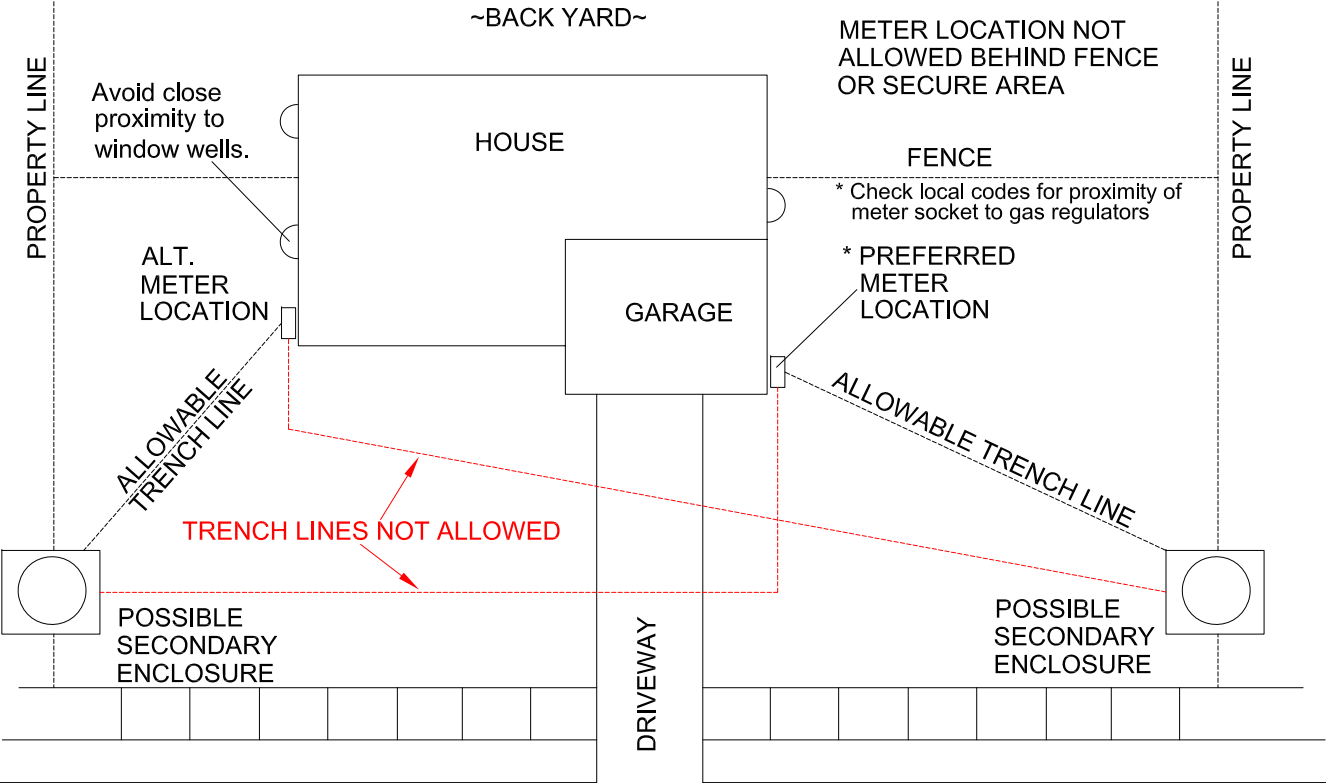

- NOTES:
- 1) IF GRADE CHANGES OCCUR AFTER INSTALLATION OF PVREA FACILITIES, THE BUILDER OR OWNER WILL BE RESPONSIBLE FOR INSURING THAT THE FACILITIES ARE RETURNED TO PROPER DEPTH SPECIFICATIONS.
  - 2) METER SOCKETS SHALL BE READILY ACCESSIBLE  
METER SOCKETS SHALL NOT BE INSTALLED BEHIND FENCES OR ON THE BACK OF THE HOUSE OR IN SECURED AREAS. METER SOCKETS MAY BE INSTALLED ON THE SIDE WALLS OF HOUSE OR GARAGE, BUT NOT BEYOND FENCES OR OTHER SECURED AREAS.
  - 3) PVREA WILL SET A METER AFTER THE STATE INSPECTOR HAS APPROVED INSTALLATION.
  - 4) NO TRENCH SHALL CROSS THE LOCATION OF A PROPOSED DRIVEWAY OR SIMILAR AREAS WHERE TRENCH SETTLEMENT MAY HAVE AN ADVERSE EFFECT OR CAUSE SIGNIFICANT DAMAGE OR FAILURE TO THE CONSUMER'S PROPERTY.
  - 5) FOR ANSWERS TO ADDITIONAL QUESTIONS CALL PVREA AT (970) 226-1234 OR (800) 432-1012.
  - 6) IF MINIMUM DEPTH AND SEPARATION AT GAS CROSSING IS NOT POSSIBLE, CONDUIT SHALL BE INSTALLED UNDER THE GAS LINE WITH A MINIMUM OF 12" SEPARATION.

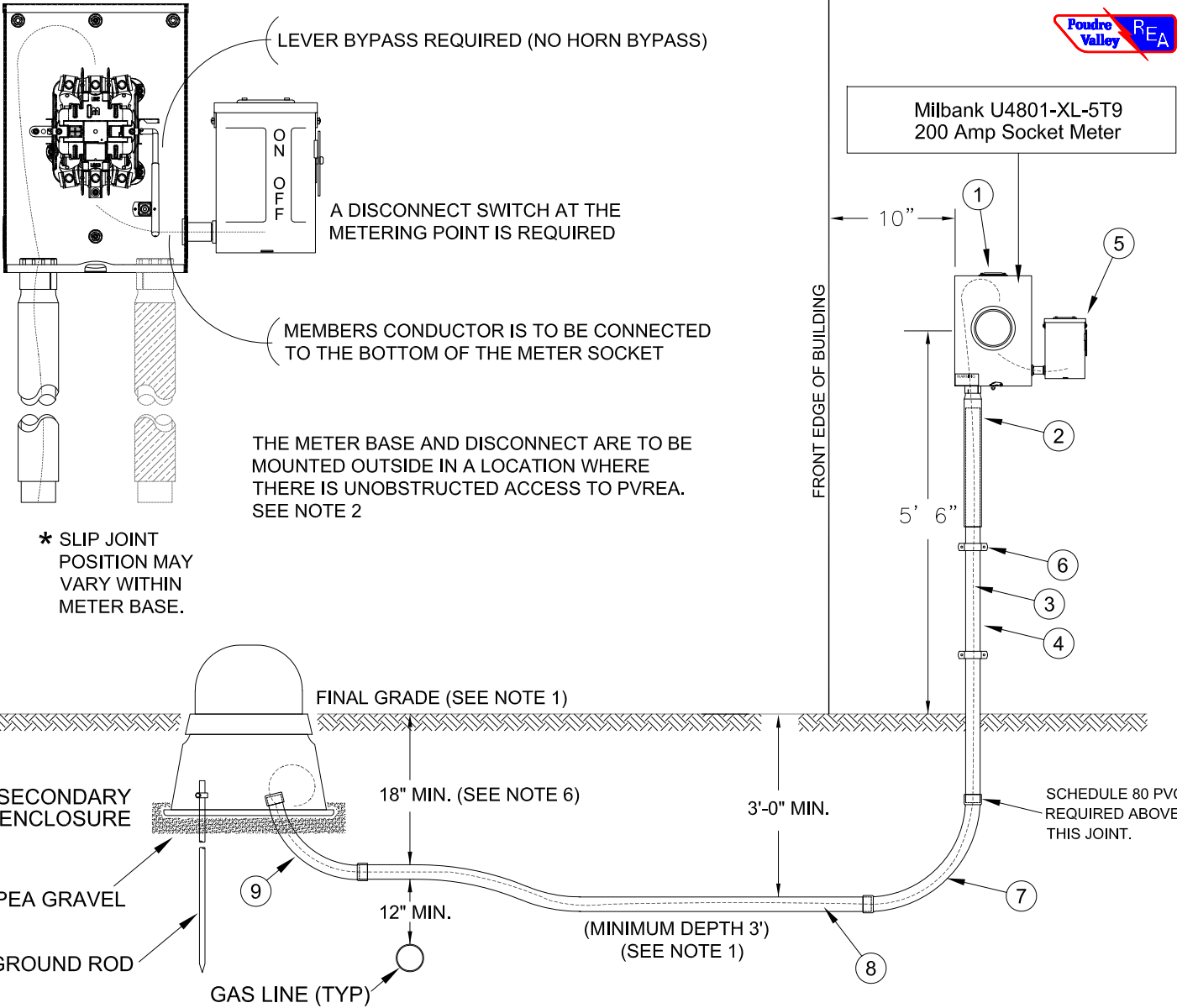

FURNISHED & INSTALLED MATERIALS

BUILDER FURNISHED AND INSTALLED EQUIPMENT	
1. 200A METER BASE - Milbank U4801-XL-5T9	
5. DISCONNECT SWITCH	
PVREA INSTALLED EQUIPMENT (VIA CONTRACTOR)	
2. SLIP JOINT WITH BUSHING LOCKNUTS	
3. SERVICE CONDUCTOR 4/0 TPX	
4. 2" CONDUIT-PVC-SCHEDULE 80	
6. STRAPS AND SCREWS AS REQUIRED	
7. 36" LONG, 18" RADIUS PVC SWEEP AS REQUIRED	
8. 2" CONDUIT-PVC-SCHEDULE 40 OR SCHEDULE 80	
9. SWEEP INTO ENCLOSURE AS REQ'D.	
10. EACH END OF WIRE MARKED FOR IDENTIFICATION	

\* PRINT THIS DOCUMENT ON 11X17 PAPER

200 AMP METER SERVICE  
SPECIFICATION SHEET  
HOUSE MOUNT TYPE

## NOTES:

1. All temp services must meet National Electric Code.
2. All temp services must be inspected and approved by the proper governing authority.
3. A PVREA account must be set up and active prior to the temp service being energized.
4. The temp service must be in good working order including the installation of all breakers and GFCI protected outlets.
5. All conductors (line and load), including the ground wire, must be installed.
6. The temp meter socket must have a lever bypass (no horn bypass).
7. The flex conduit must be 2" diameter or less and must be long enough to reach the nearest PVREA enclosure.
8. The flex conduit must reach the PVREA enclosure without creating any tripping hazards.
9. The temp service must be located on the subject property address side of the PVREA enclosure.
10. The line side triplex conductor and #4 CU solid ground wire must be a minimum length of 3' longer than the flex conduit.
11. The property address number must be legible, weatherproof, and securely affixed to the temp service.
12. The temp service must be screwed securely to the post with a minimum of two screws.
13. The post must be a minimum size of 4" x 4" and must be buried to a minimum depth of 2'-6" or be mounted on a self supporting base.
14. 811 Locates are required for the post installation.

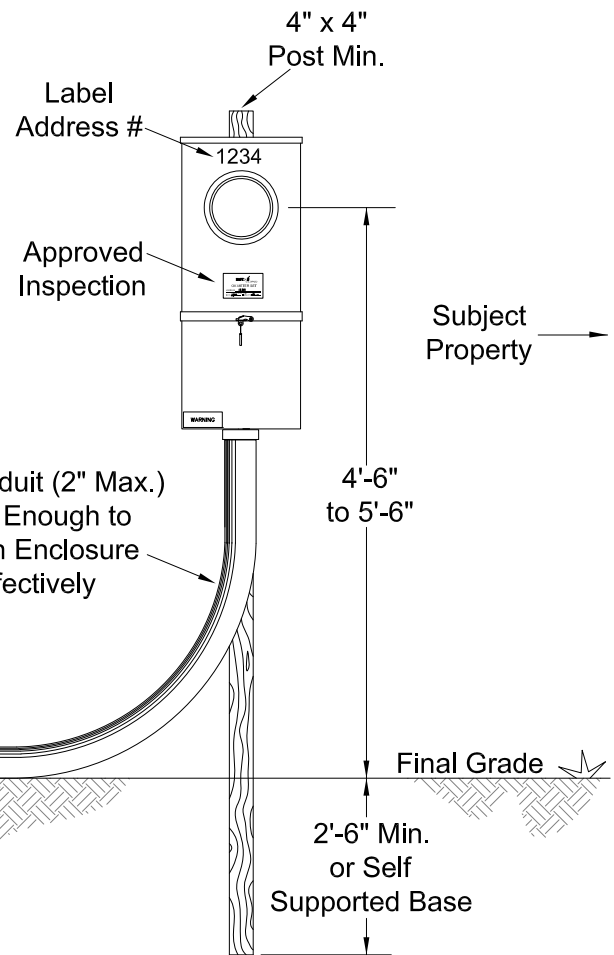
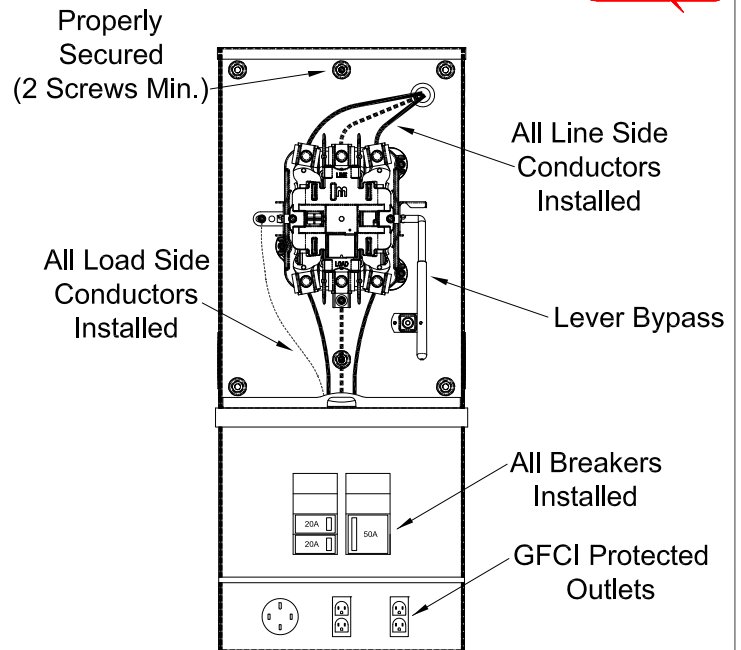

PVREA Enclosure  
For Reference Only  
**DO NOT ENTER**

Triples Line Side  
Conductor & #4 CU  
Solid Ground Wire  
(3' Min. Longer than  
the Flex Conduit)

Flex Conduit (2" Max.)  
Long Enough to  
Reach Enclosure  
Effectively

Flex Conduit  
Must Not Create  
Any Tripping  
Hazards



DESIGN LIMITS:

TEMPORARY CONSTRUCTION SERVICE  
INSTALLATION GUIDE

DATE: 3/28/2022

CHKD: RBP

APPVD: MO

POUDRE VALLEY  
RURAL ELECTRIC ASSOCIATION

Temp  
Service